

Group 3E RECOGNITION DOCUMENT

A) Vehicle seen from 3/4 front



B) Vehicle seen from 3/4 rear



1. GENERAL

101. Manufacturer **HOLDEN LTD**
102. Commercial name(s) - Model and type **VE COMMODORE SS SEDAN**
103. Engine capacity **5967** cm³ Corrected engine capacity **5967 x 1 = 5967** cm³
104. Type of car construction
- | | | |
|---------|---|---|
| a) Type | <input type="checkbox"/> separate chassis | <input checked="" type="checkbox"/> monocoque |
|---------|---|---|
- b) Material of chassis / bodyshell **STEEL**
106. Number of seats **5**

2. DIMENSIONS, WEIGHT

- Minimum Racing Weight **1615** kg
202. Overall length **4895** mm ± 1 %
203. Maximum overall width **2100** mm ± 1 % Where measured **EXTERIOR SIDE MIRRORS**
204. Width of bodywork
- | | |
|------------------|----------------------|
| a) At front axle | 1880 mm ± 1 % |
| b) At rear axle | 1898 mm ± 1 % |
206. Wheelbase **2915** mm ± 1 %
207. Maximum track
- | | |
|-------------------------|------------------------|
| a) Front 1592 mm | b) Rear 1608 mm |
|-------------------------|------------------------|

3. ENGINE (In case of rotary engine, see Art. 335 on additional form)

301. Location and position of the engine **FRONT / CENTRAL**

302. Number of mounts **2**

Engine in its compartment



304. Supercharging yes no

Maximum manifold pressure **N/A**

Type and number of compressors **N/A**

305. Number and layout of cylinders **8 / 90° V**

312. Cylinder block material **ALUMINIUM ALLOY**

310. Maximum compression ratio **10.4 : 1**



313. Sleeves a) yes no b) Material **STEEL** c) wet dry

314. Bore **101.6** +0/- 0.1 mm

316. Stroke **92** +0/- 0.1 mm

321. Cylinderhead a) Number **2** b) Material **ALUMINIUM ALLOY**

324. Fuel feed by injection : a) Make **GM** b) Model **DELPHI**

f) Position of Injectors:

f1) Manifold Cylinderhead

325. Camshaft a) Number **1** b) Location **CYLINDER BLOCK**

c) Drive system **CHAIN** f) Type of valve operation **PUSHROD AND ROCKER**

327. Intake

a) Material of manifold **PLASTIC** c) Number of valves per cylinder **1**
 b) Number of manifold elements **1**



328. Exhaust

- a) Material of manifold **CAST IRON**
- b) Number of manifold elements **1**
- d) Number of valves per cylinder **1**
- p) External Diameter of exhaust pipe between manifold and first silencer **58.7** mm ± 5%

330. Ignition system

- a) Type **ELECTRONIC**
- b) Number of plugs per cylinder **1**
- c) Number of distributors **0**
- d) Number of coils **8**

331. Cooling system Capacity **11 L**

- a) Number **2**
- b) Diameter of the fan _____ mm
- c) Material of the fan **PLASTIC**
- d) Number of blades _____
- e) Type of drive **ELECTRIC**
- f) Automatic cut in

<input checked="" type="checkbox"/> yes	<input type="checkbox"/> no
---	-----------------------------

333. Lubrication system

- a) Type **WET SUMP**
- b) Number of oil pumps **1**
- c) Total capacity **8.2 L**
- e) Location of the cooler(s) **NA**
- f) Type of the cooler(s) **NA**

4. FUEL CIRCUIT

- 401. Fuel tank**
- b) Location **UNDER REAR PASSENGER FLOOR**
- d) Total capacity **73 L**

- 402. Fuel pump(s)**
- a)

<input checked="" type="checkbox"/> Eleectrical	<input type="checkbox"/> Mechanical
---	-------------------------------------
- b) Number **1**
- d) Location **FUEL TANK**

5. ELECTRICAL EQUIPMENT

- 502. Alternator**
- a) Number **1**
- b) Type **SC2**
- c) Drive system **BELT**
- d) Nominal power **155** Amp

- 503. Retractable headlights**
- a)

<input type="checkbox"/> yes	<input checked="" type="checkbox"/> no
------------------------------	--
- b) Control system **N/A**

6. POWER TRAIN



601. Driven wheels front yes no rear yes no

602. Clutch a) Type **DIAPHRAM**

b) Control system **HYDRAULIC**

603. Gearbox a) Location **MID CENTRAL** b) Make **TREMEC**

c) Type and location of control **H PATTERN FLOOR SHIFT**

e) Ratios

	Number of teeth	Ratio	Constant Mesh	Synchro
1	—	<u>3.01</u>	—	<u>Y</u>
2	—	<u>2.07</u>	—	<u>Y</u>
3	—	<u>1.43</u>	—	<u>Y</u>
4	—	<u>1.00</u>	—	<u>Y</u>
5	—	<u>0.84</u>	—	<u>Y</u>
6	—	<u>0.57</u>	—	<u>Y</u>
R	—	—	—	<u>Y</u>
Constant	—	—	—	—



604. Transfer box / Centre differential

a) Ratios **N/A**

c) Control system of transfer box **N/A**

d) Type of central differential **N/A**

605. Final drive

a) Type of final drive

Front

Rear

N/A

HYPOID

b) Ratio

N/A

3.45:1

f) Oil Cooler

yes

no

yes

no

g) Cooler Type

N/A

N/A

606. Shafts

a) Type of longitudinal shafts

HOLLOW 2 PIECE

b) Material of longitudinal shafts

STEEL

c) Type of transversal half-shafts

SOLID

d) Material of transversal half-shafts

STEEL

7. SUSPENSION



Make **Holden**

Model **Commodore VE SS**

SPC Recognition Document

3-10-008

701. General

	Front	Rear
a) Type of suspension	INDEPENDENT MCPHERSON STRUT	DOUBLE A
	<input checked="" type="checkbox"/> yes <input type="checkbox"/> no	<input checked="" type="checkbox"/> yes <input type="checkbox"/> no
a) Material	STEEL	STEEL
703. Leaf springs	<input type="checkbox"/> yes <input checked="" type="checkbox"/> no	<input type="checkbox"/> yes <input checked="" type="checkbox"/> no
a) Material	N/A	N/A
704. Torsion bars	<input type="checkbox"/> yes <input checked="" type="checkbox"/> no	<input type="checkbox"/> yes <input checked="" type="checkbox"/> no
a) Material	N/A	N/A

705. Other type of suspension See description on additional form

706. Stabiliser

	Front	Rear
b) Effective diameter	26 mm	18 mm
c) Material	STEEL	STEEL

707. Suspension Dampers

	Front	Rear
a) Number per wheel	1	1
b) Type	TELESCOPIC	TELESCOPIC
c) Principle of operation	HYDRAULIC	HYDRAULIC

8. WHEELS

801. Wheels

	Front	Rear
a) Diameter	18"	18"
b) Width	8"	8"
c) Offset	+48 mm	+48 mm

803. Brakes

a) Braking system

HYDRAULIC

b) Number of master cylinders

1

c) Servo-brakes

yes no

c1) Make and type _____



	Front	Rear
e) Number of cylinders per wheel	<u>2</u>	<u>1</u>
f) Drum brakes		
f1) Internal diameter	<u>N/A</u>	<u>N/A</u>
f2) Number of linings per wheel	<u>N/A</u>	<u>N/A</u>
g) Disc brakes		
g1) Number of pads per wheel	<u>2</u>	<u>2</u>
g2) Number of calipers per wheel	<u>1</u>	<u>1</u>
g3) Caliper material	<u>Aluminium alloy</u>	<u>Aluminium alloy</u>
g4) Thickness of new disc	<u>30 ± 1 mm</u>	<u>22 ± 1 mm</u>
g5) External diameter of the disc	<u>321 ± 1.5 mm</u>	<u>324 ± 1.5 mm</u>
g9) Ventilated discs	<input checked="" type="checkbox"/> yes <input type="checkbox"/> no	<input checked="" type="checkbox"/> yes <input type="checkbox"/> no

h) Parking brake: h1) Control system CABLE Front Rear
 h2) Location of lever CENTER CONSOLE h3) On which wheels Front Rear

804. Steering

a) Type
 b) Servo-assistance
 Type of Assistance

Front		Rear	
<u>RACK AND PINION</u>		<u>N/A</u>	
<input checked="" type="checkbox"/> yes	<input type="checkbox"/> no	<input type="checkbox"/> yes	<input checked="" type="checkbox"/> no
<u>HYDRAULIC</u>		<u>N/A</u>	

9. BODYWORK

901. Interior

a) Ventilation yes no
 c) Air Conditioning yes no

b) Heating yes no

f) Optional sun roof yes no

f1) Type YES f2) Control system ELECTRIC

g) Opening system for side windows

Front	Rear
<u>ELECTRIC</u>	<u>ELECTRIC</u>



Make Holden

Model Commodore VE SS

SPC Recognition Document

3-10-008

X) Dashboard



Y) Sunroof



902. Exterior

a) Number of doors **4**

b) Tailgate

<input type="checkbox"/> yes	<input checked="" type="checkbox"/> no
------------------------------	--

c) Door material

Front	Rear
<u>STEEL</u>	<u>STEEL</u>

d) Front bonnet material

STEEL

e) Rear bootlid / tailgate material

STEEL

f) Bodywork material

STEEL

h) Rear window material

GLASS

i) Rear quarter window material

GLASS

k) Side window material

Front	Rear
<u>GLASS</u>	<u>GLASS</u>
<u>PLASTIC</u>	<u>PLASTIC</u>

l) Material of bumper

PLASTIC

PLASTIC

n) Exterior Rear wiper

<input type="checkbox"/> yes	<input checked="" type="checkbox"/> no
------------------------------	--

Make

Holden

Model

Commodore VE SS

SPC Recognition Document

3-10-008

XIII) NON METALLIC PARTS OF THE BODY

Number	Part	Material
92161017	Front Facia	Plastic
92214064	Rear Facia	Plastic
92162071	LH Rocker Panel Molding	Plastic
92162072	RH Rocker Panel Molding	Plastic
92194164	Spare Wheel Well	Plastic

Make **Holden**

Model **Commodore VE SS**

SPC Recognition Document

3-10-008

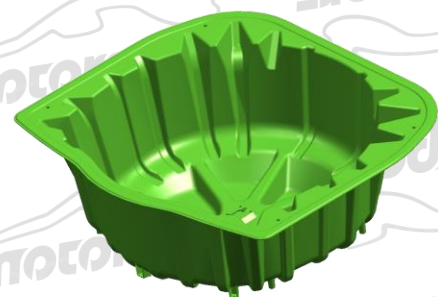

Spare Wheel Well



Front Facia

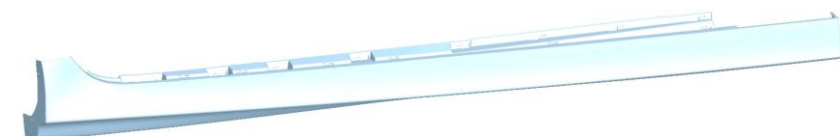

RH Side Skirt



LH Side Skirt

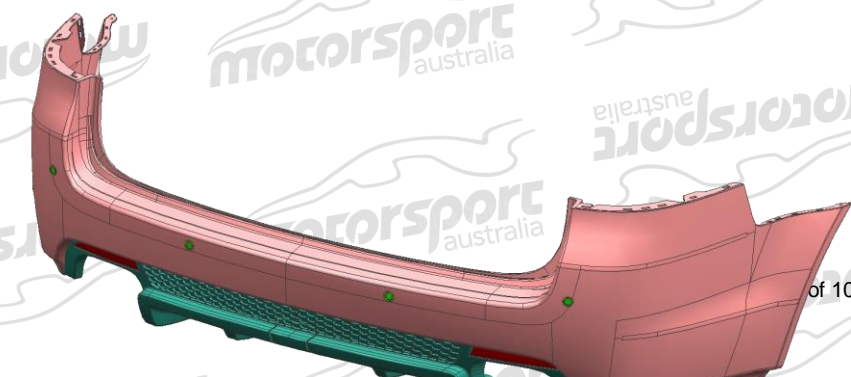

Make Holden

Model Commodore VE SS

SPC Recognition Document

3-10-008

COMPLEMENTARY INFORMATION

