

Group 3E Recognition Document

A) Vehicle seen from 3/4 front



B) Vehicle seen from 3/4 rear



1. GENERAL

101. Manufacturer

BMW

102. Commercial name(s) - Model and type

E46 M3

103. Engine capacity

3246 cm³

Corrected engine capacity

3246 x **1.0** = **3246** cm³

104. Type of car construction

a) Type



separate chassis



monocoque

b) Material of chassis / bodyshell

STEEL/ALUMINIUM

106. Number of seats

4

2. DIMENSIONS, WEIGHT

Minimum Racing Weight **1455** kg202. Overall length **4492** mm ± 1 %203. Maximum overall width **1925** mm ± 1 % Where measured **SIDE MIRRORS**

204. Width of bodywork

a) At front axle

1760 mm ± 1 %

b) At rear axle

1787 mm ± 1 %206. Wheelbase **2731** mm ± 1 %

207. Maximum track

Make **BMW**

Model **E46 M3**

a) Front **1508** mm

b) Rear **1525** mm

3. ENGINE (In case of rotary engine, see Art. 335 on additional form)

301. Location and position of the engine **FRONT**

302. Number of mounts **2**

Engine in its compartment



304. Supercharging

yes

no

Maximum manifold pressure

Type and number of compressors

305. Number and layout of cylinders **IL 6**

312. Cylinder block material **CAST IRON**

310. Maximum compression ratio **11.5 : 1**

313. Sleeves

a)

yes

no

b) Material

c)

wet

dry

314. Bore **87** +0/- 0.1 mm

316. Stroke **91** +0/- 0.1 mm

321. Cylinderhead a) Number **1**

b) Material

ALUMINIUM

324. Fuel feed by injection : a) Make **BOSCH/BMW**

b) Model **BMW**

f) Position of Injectors:

f1)

Manifold

Cylinderhead

325. Camshaft a) Number

2

b) Location

OVERHEAD

c) Drive system

CHAIN

f) Type of valve operation

ROCKER

327. Intake

a) Material of manifold

ALUMINIUM

Make **BMW**Model **E46 M3**b) Number of manifold elements **6**c) Number of valves per cylinder **2****328. Exhaust**a) Material of manifold **STEEL**b) Number of manifold elements **2**d) Number of valves per cylinder **2**p) External Diameter of exhaust pipe between manifold and first silencer **56** mm ± 5%**330. Ignition system**a) Type **ELECTRONIC**b) Number of plugs per cylinder **1**c) Number of distributors **N/A**d) Number of coils **6****331. Cooling system** Capacity **10** L**332. Cooling fan** a) Number **1**b) Diameter of the fan **420** mmc) Material of the fan **PLASTIC**d) Number of blades **11**e) Type of drive **VISCOUS VIA BELT**f) Automatic cut in yes no**333. Lubrication system**a) Type **MECHANICAL**b) Number of oil pumps **1**c) Total capacity **6** Le) Location of the cooler(s) **BELOW RADIATOR**f) Type of the cooler(s) **AIR COOLED****4. FUEL CIRCUIT****401. Fuel tank**b) Location **UNDER REAR SEAT**d) Total capacity **64** L**402. Fuel pump(s)**a) Elelectrical Mechanicalb) Number **1**d) Location **IN TANK**Fuel Pressure **5 BAR****5. ELECTRICAL EQUIPMENT****502. Alternator**a) Number **1**b) Type **VALEO**c) Drive system **BELT**d) Nominal power **120** Amp**503. Retractable headlights**a) yes no

b) Control system _____

6. POWER TRAIN**601. Driven wheels**front yes norear yes no**602. Clutch**a) Type **SINGLE**b) Control system **HYDRAULIC**

Make **BMW**

Model **E46 M3**

Recognition N°

3-18-007

603. Gearbox

- a) Location **IN LINE**
- b) Make **GETRAG**
- c) Type and location of control **MANUAL - ON TRANSMISSION TUNNEL**
- e) Ratios

	Number of teeth	Ratio	Constant Mesh	Synchro
1	_____	4.23	_____	Y
2	_____	2.53	_____	Y
3	_____	1.67	_____	Y
4	_____	1.23	_____	Y
5	_____	1.0	_____	Y
6	_____	0.830	_____	Y
R	_____	3.75	_____	N
Constant	_____	_____	_____	_____

f) Gear change gate

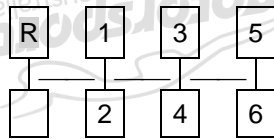

604. Transfer box / Centre differential

- a) Ratios _____
- c) Control system of transfer box _____
- d) Type of central differential _____

605. Final drive

	Front	Rear
a) Type of final drive	N/A	LSD
b) Ratio	_____	3.62
f) Oil Cooler	<input type="checkbox"/> yes <input type="checkbox"/> no	<input checked="" type="checkbox"/> yes <input type="checkbox"/> no
g) Cooler Type	_____	FINS

606. Shafts

- a) Type of longitudinal shafts **1**
- b) Material of longitudinal shafts **ALLOY**
- c) Type of transversal half-shafts **2**
- d) Material of transversal half-shafts **STEEL**



Make **BMW**

Model **E46 M3**

Recognition N°

3-18-007

7. SUSPENSION

701. General

a) Type of suspension

Front		Rear	
MACPHERSON STRUT		MULTI LINK	
<input checked="" type="checkbox"/> yes	<input type="checkbox"/> no	<input checked="" type="checkbox"/> yes	<input type="checkbox"/> no
STEEL		STEEL	

702. Helical springs

a) Material

705. Other type of suspension

See description on additional form

706. Stabiliser

b) Effective diameter

c) Material

Front	Rear
26 mm	21.5 mm
STEEL	STEEL

707. Suspension Dampers

a) Number per wheel

b) Type

c) Principle of operation

Front	Rear
1	1
MACPHERSON STRUT	SHOCK
HYDRAULIC	HYDRAULIC

8. WHEELS

801. Wheels

a) Diameter

b) Width

c) Offset

Front	Rear
19"	19"
8.5"	9.5"
+47 mm	+27 mm

803. Brakes

a) Braking system

b) Number of master cylinders

c) Servo-brakes

4 WHEEL DISC

1

yes no

c1) Make and type

ATE VACUUM BOOSTED



Make **BMW**

Model **E46 M3**

Recognition N°

3-18-007

	Front	Rear
e) Number of cylinders per wheel	1	1
g) Disc brakes		
g1) Number of pads per wheel	2	2
g2) Number of calipers per wheel	1	1
g3) Caliper material	STEEL	STEEL
g4) Thickness of new disc	28 ± 1 mm	20 ± 1 mm
g5) External diameter of the disc	345 ± 1.5 mm	328 ± 1.5 mm
g9) Ventilated discs	<input checked="" type="checkbox"/> yes <input type="checkbox"/> no	<input checked="" type="checkbox"/> yes <input type="checkbox"/> no

h) Parking brake: h1) Control system **MECHANICAL**

h2) Location of lever **TRANSMISSION TUNNEL**

On which wheels

Effet sur roues

h3) Front Rear

804. Steering

a) Type

b) Servo-assistance

Type of Assistance

Front		Rear	
RACK AND PINION			
<input checked="" type="checkbox"/> yes	<input type="checkbox"/> no	<input type="checkbox"/> yes	<input type="checkbox"/> no
HYDRAULIC			

9. BODYWORK

901. Interior

a) Ventilation

<input checked="" type="checkbox"/> yes	<input type="checkbox"/> no
<input checked="" type="checkbox"/> yes	<input type="checkbox"/> no

c) Air Conditioning

b) Heating

<input checked="" type="checkbox"/> yes	<input type="checkbox"/> no
---	-----------------------------

f) Optional sun roof

<input checked="" type="checkbox"/> yes	<input type="checkbox"/> no
---	-----------------------------

f1) Type

SLIDING PANEL

f2)

Control system

ELECTRIC

g) Opening system for side windows

Front	Rear
ELECTRIC	MANUAL OR ELECTRIC

X) Dashboard

Y) Sunroof

Make **BMW**

Model **E46 M3**

Recognition N°

3-18-007



902. Exterior

a) Number of doors **2**

b) Tailgate

<input type="checkbox"/> yes	<input checked="" type="checkbox"/> no
------------------------------	--

c) Door material

Front	Rear
<u>STEEL</u>	<u>N/A</u>

d) Front bonnet material

ALUMINIUM

e) Rear bootlid / tailgate material

STEEL

f) Bodywork material

STEEL

h) Rear window material

GLASS

i) Rear quarter window material **N/A**

k) Side window material

Front	Rear
<u>GLASS</u>	<u>GLASS</u>
<u>PLASTIC</u>	<u>PLASTIC</u>

l) Material of bumper

n) Exterior Rear wiper

<input type="checkbox"/> yes	<input checked="" type="checkbox"/> no
------------------------------	--

XIII) NON METALLIC PARTS OF THE BODY

Number	Part	Material
1	Front Bumper Bar	Plastic
2.	Front bumper carrier	Carbon Fibre
3	Rear Bumper Bar	Plastic
4	Rear Bumper Carrier	Carbon Fibre



5	Side skirts	Plastic
6	Mirrors	Plastic
7	Rear boot lip	Plastic

1. Front Bumper and 2. Front Bumper carrier

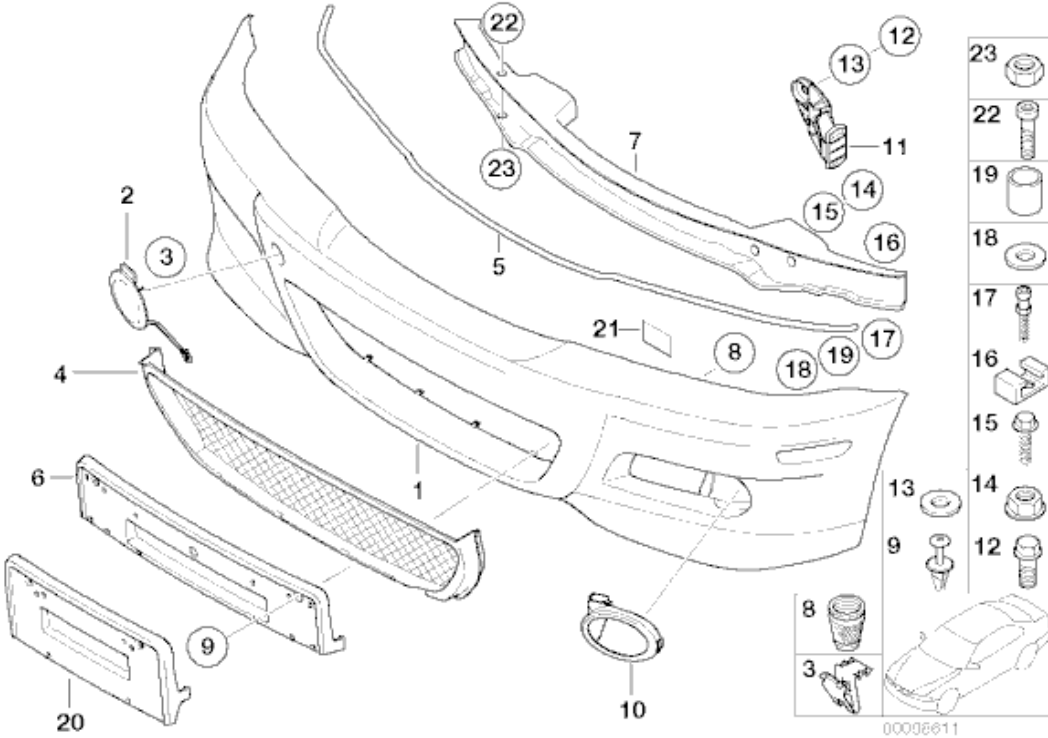

3. Rear Bumper and 4. Rear Bumper carrier

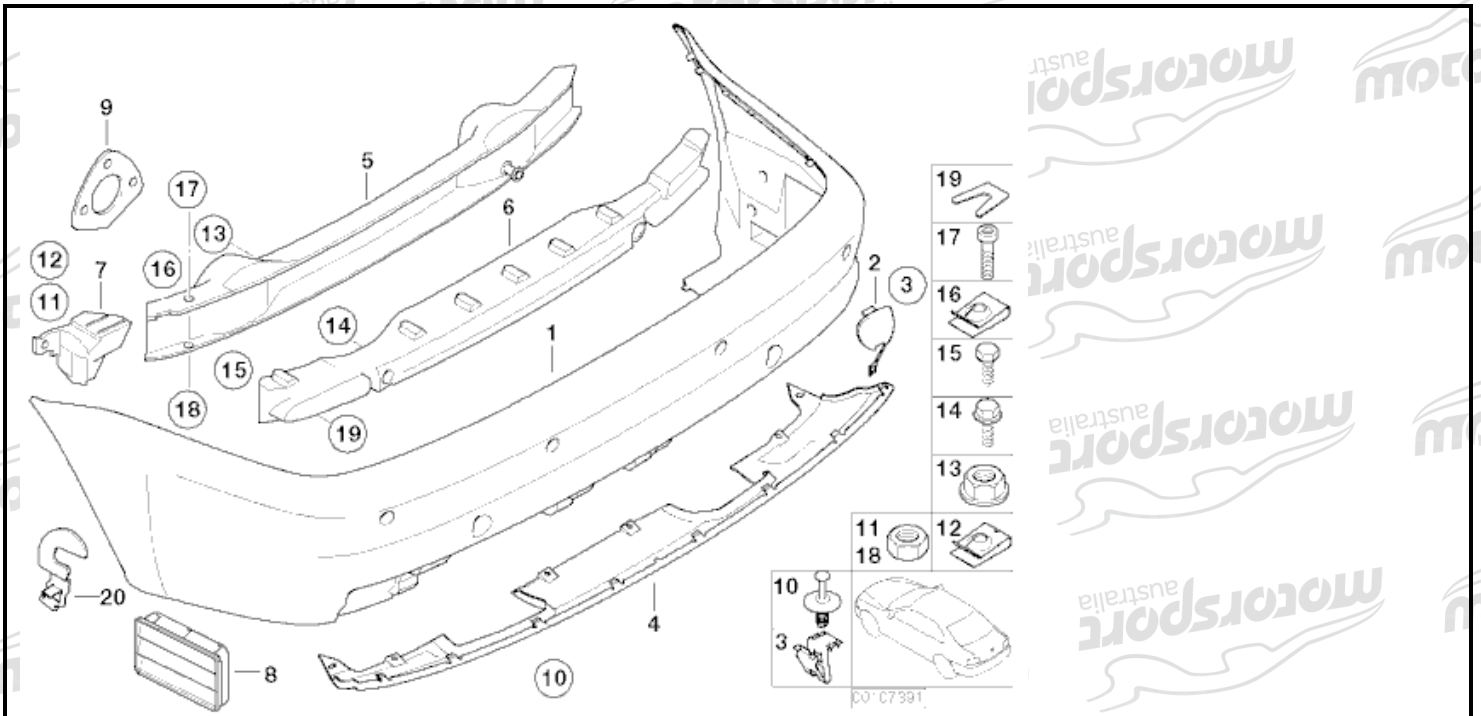

5. Side Skirts

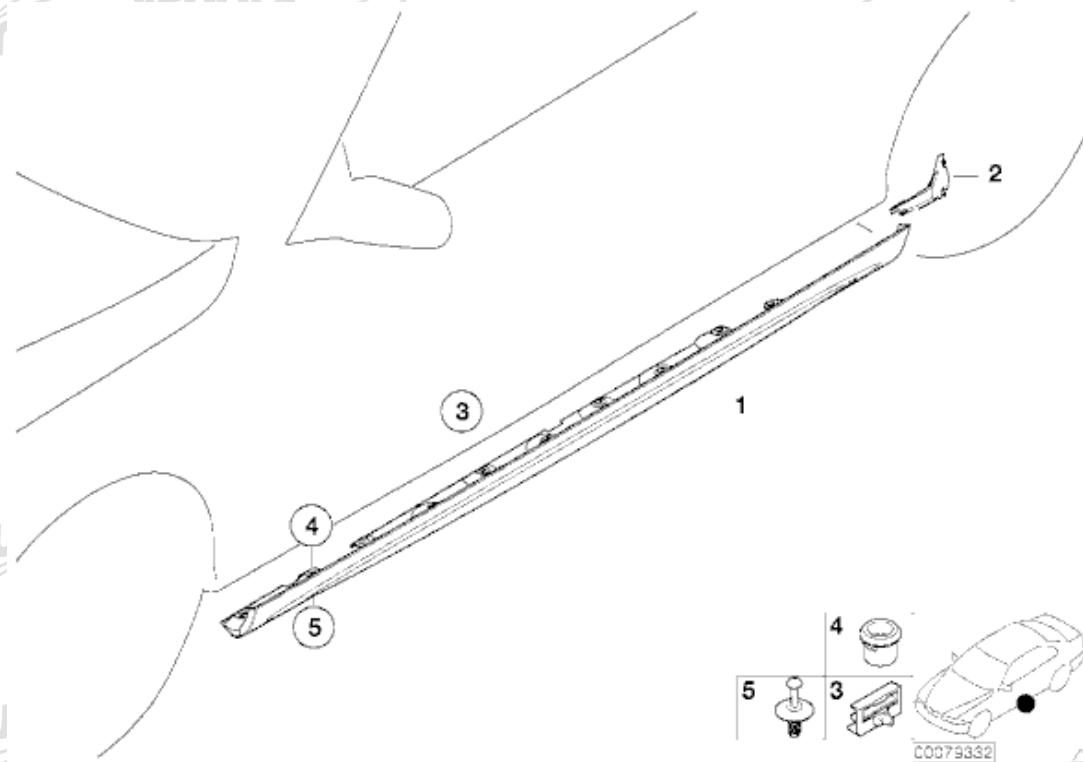

6. Side Mirrors

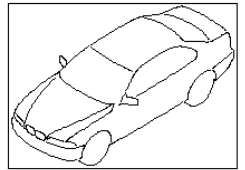
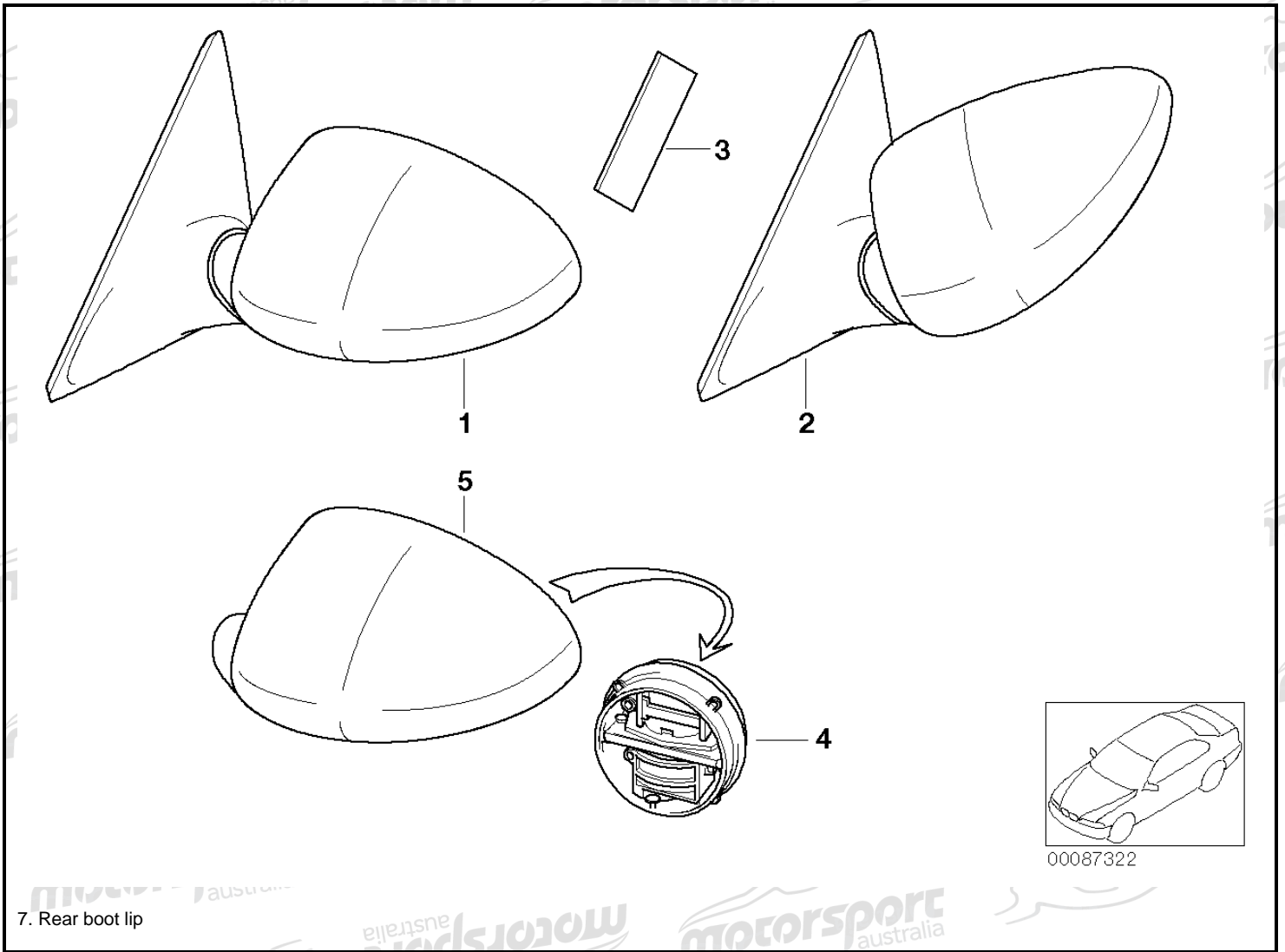

00087322

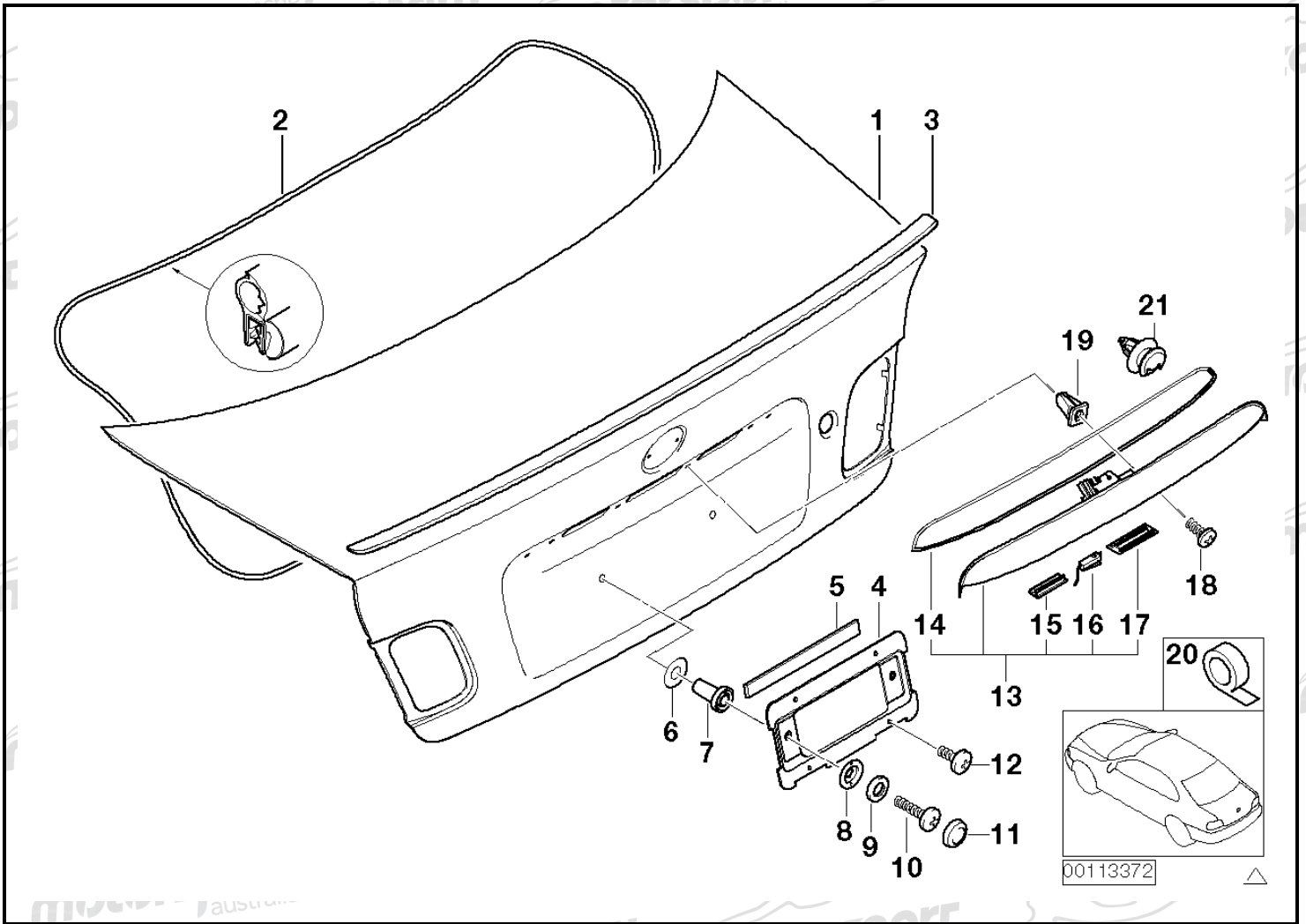

Make **BMW**

Model **E46 M3**

Recognition N°

3-18-007

COMPLEMENTARY INFORMATION

